



# BEACON FEN

## ENERGY PARK

Planning Inspectorate Reference: EN010151

Figure 3.3 Alternative Access Routes  
Document Reference: 6.4 ES Volume 3, 6.4.8  
April 2025





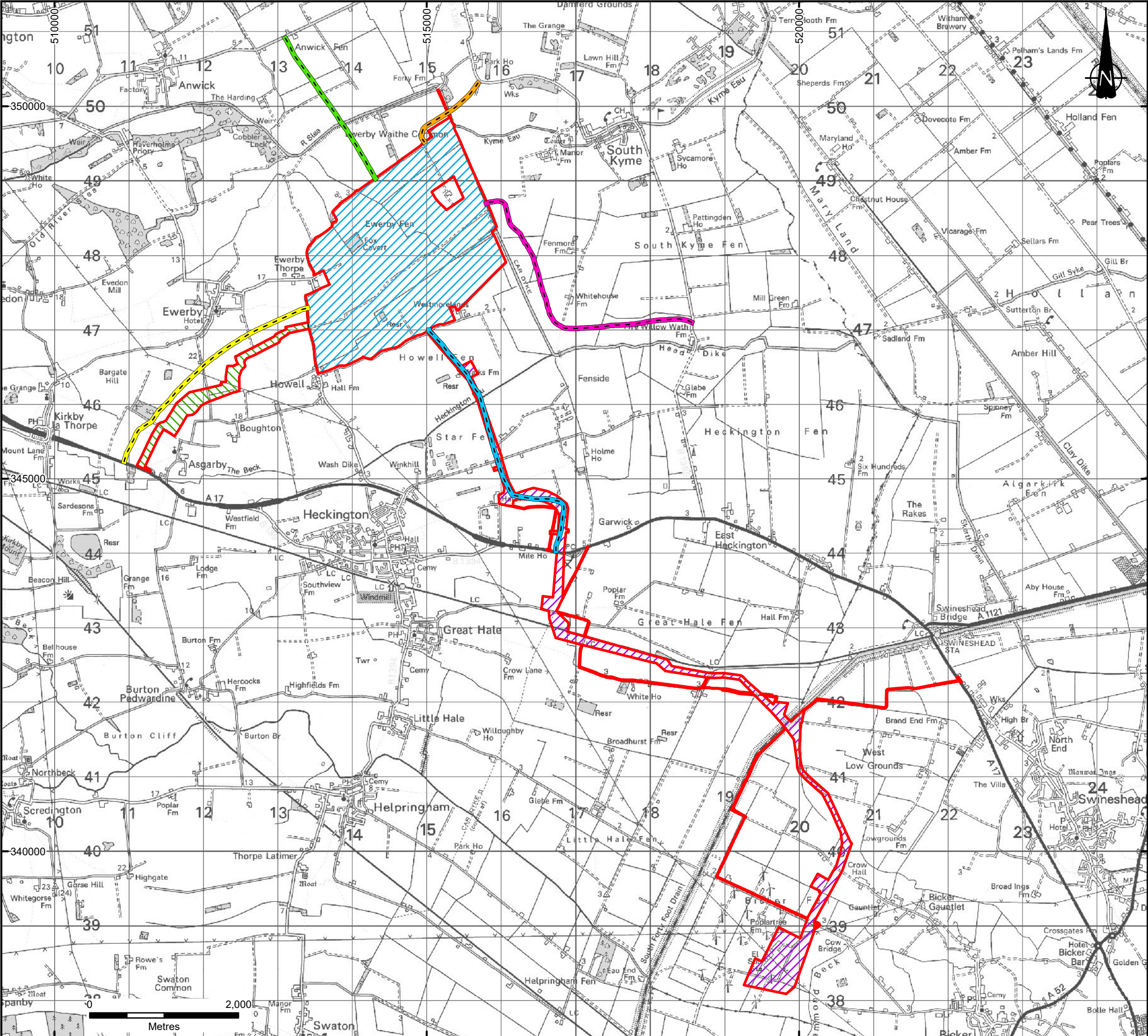

**KEY**

- DCO Order Limits
- Solar Array Area
- Bespoke Access Corridor
- Cable Route Corridor

**Access Corridor Options**

- Option 1 from A17
- Option 2 from A17
- Option 3 from B1395
- Option 4 from B1395
- Option 5 from A153

**Notes:**

The lines shown illustrate the approximate route of each corridor that was considered and do not identify specific routes.

DCO Order Limits provided by Ardent Management on 04/02/2025.

© Crown copyright and database rights 2025 Ordnance Survey Licence No. AC0000808122

1	FIRST ISSUE	03/03/25	BL	RS	SR
REVISION	DETAILS	DATE	DRAWN	CHKD	APPD
CLIENT	BEACON FEN ENERGY PARK LTD				
PROJECT	BEACON FEN ENERGY PARK				
DRAWING TITLE	FIGURE 3.3 ALTERNATIVE ACCESS ROUTES				
DRG No.	ST19595-175	REV	1	SUIT. CODE	---
DRG SIZE	A3	SCALE	1:50,000	DATE	04/03/2025
DRAWN BY	RCB	CHECKED BY	RS	APPROVED BY	SR

PART OF SLR